

NOTICE!!

These documents have been scanned!

Do not place un-scanned documents beneath this notice!

Do not remove this notice from this file!

GPO Jacket No. 560-102
Print Order 61540
Rise Business Services, LLC
Job=AZ15 5/21/2019



Box Number= AZ15075



Claim Begin-End: AMC452773-AMC452778

1 Initial Receipt



AZ15075-38

AMC452444-AMC452831

United States Department of the Interior
Bureau of Land Management
 DIV OF LANDS, MINRLS & ENERGY
 ONE N CENTRAL AVE
 PHOENIX, AZ 85004 -4427
 Phone: 602-417-9200

| Receipt | |
|---------|---------|
| No: | 4338637 |

Transaction #: 4455456
Date of Transaction: 12/19/2018

| CUSTOMER: | |
|---|--|
| MICHAEL MARRON JAMES PO BOX 1007 CAREFREE, AZ 85377-1007 US |  |

| LINE # | QTY | DESCRIPTION | REMARKS | UNIT PRICE | TOTAL |
|---------------|------|---|---------|------------|-------------------|
| 1 | 6.00 | LOCATABLE MINERALS / MINING CLAIMS-NEW, UNADJUD, ONE OR MORE AUTH NOS / NEW MINING CLAIM PROCESSING FEE CASES: AMC452773/\$20.00, AMC452774/\$20.00, AMC452775/\$20.00, AMC452776/\$20.00, AMC452777/\$20.00, AMC452778/\$20.00 | | - n/a - | 120.00 |
| 2 | 6.00 | LOCATABLE MINERALS / MINING CLAIMS-NEW, UNADJUD, ONE OR MORE AUTH NOS / NEW MINING CLAIMS LOCATION FEE CASES: AMC452773/\$37.00, AMC452774/\$37.00, AMC452775/\$37.00, AMC452776/\$37.00, AMC452777/\$37.00, AMC452778/\$37.00 | | - n/a - | 222.00 |
| 3 | 6.00 | LOCATABLE MINERALS / MINING CLAIMS-NEW, UNADJUD, ONE OR MORE AUTH NOS / NEW MINING CLAIMS MAINTENANCE FEE CASES: AMC452773/\$155.00, AMC452774/\$155.00, AMC452775/\$155.00, AMC452776/\$155.00, AMC452777/\$155.00, AMC452778/\$155.00 | | - n/a - | 930.00 |
| TOTAL: | | | | | \$1,272.00 |

| PAYMENT INFORMATION | | | |
|---------------------|-----------|---|----------------------|
| 1 | AMOUNT: | 1272.00 | POSTMARKED: N/A |
| | TYPE: | CHECK | RECEIVED: 12/19/2018 |
| | CHECK NO: | 1584 | |
| | NAME: | MARRON JAMES, MICHAEL PO BOX 1007 CAREFREE AZ 85377-1007 US | |

NOTICE!!

These documents have been scanned!

Do not place un-scanned documents beneath this notice!

Do not remove this notice from this file!

GPO Jacket No. 560-102
Print Order 61540
Rise Business Services, LLC
Job=AZ15 5/21/2019



Box Number= AZ15075



Claim Begin-End: AMC452773-AMC452778

2 Correspondence



AZ15075-38

AMC452444-AMC452831

**NO
DOCUMENTS
FOUND**

NO DOCUMENTS FOUND
NO DOCUMENTS FOUND

NOTICE!!

These documents have been scanned!

Do not place un-scanned documents beneath this notice!

Do not remove this notice from this file!

GPO Jacket No. 560-102
Print Order 61540
Rise Business Services, LLC
Job=AZ15 5/21/2019



Box Number= AZ15075



Claim Begin-End: AMC452773-AMC452778

3 Transfers



AZ15075-38

AMC452444-AMC452831

**NO
DOCUMENTS
FOUND**

NO DOCUMENTS FOUND
NO DOCUMENTS FOUND

NOTICE!!

These documents have been scanned!

Do not place un-scanned documents beneath this notice!

Do not remove this notice from this file!

GPO Jacket No. 560-102
Print Order 61540
Rise Business Services, LLC
Job=AZ15 5/21/2019



Box Number= AZ15075



Claim Begin-End: AMC452773-AMC452778

4 Annual Filings



AZ15075-38

AMC452444-AMC452831

452773

439 PER

Form 3830-2
(January 2017)

UNITED STATES
DEPARTMENT OF THE INTERIOR
BUREAU OF LAND MANAGEMENT

MAINTENANCE FEE WAIVER CERTIFICATION

FORM APPROVED
OMB NO. 1004-0114
Expires: January 31, 2020

SEE INSTRUCTIONS ON PAGE 2

- This small miner waiver is filed for the assessment year beginning on September 1, 2019 and ending on September 1, 2020.
- The undersigned and all related parties owned ten or fewer mining claims, mill, or tunnel sites located and maintained on Federal lands in the United States of America on September 1, 2019.
- The undersigned have performed the assessment work required by law for each mining claim listed prior to filing this waiver and understand that by filing this form, the undersigned must file an affidavit of assessment work with the Bureau of Land Management (BLM) by the December 30th following the filing of this waiver.
- The undersigned understand that if the assessment work obligation has not yet come due under 30 U.S.C. 28 (for those claims in their first assessment year only), a notice of intent to hold reciting this condition must be recorded by the December 30th following the filing of this waiver.
- The undersigned understand that mill and tunnel sites may also be listed on this waiver and be waived from payment of the maintenance fee, and that a notice of intent to hold for these sites is required to be filed with the BLM by the December 30th following the filing of this waiver.
- The undersigned understand and acknowledge that pursuant to 43 U.S.C. 1212 and 18 U.S.C. 1001, the filing or recording of a false, fictitious, or fraudulent document with the BLM may result in a fine of up to \$250,000, a prison term not to exceed five years, or both.
- The mining claims, mill or tunnel sites for which this waiver from payment of the maintenance fees is requested are:

| CLAIM OR SITE NAME | BLM RECORDATION SERIAL NUMBER |
|----------------------|-------------------------------|
| 1. Mommy's Burden #1 | AMC452773 |
| 2. Mommy's Burden #2 | AMC452774 |
| 3. Mommy's Burden #3 | AMC452775 |
| 4. Mommy's Burden #4 | AMC452776 |
| 5. Mommy's Burden #5 | AMC452777 |
| 6. Mommy's Burden #6 | AMC452778 |
| 7. | |
| 8. | |
| 9. | |
| 10. | |

RECEIVED
BLM AZ STATE OFFICE
2019 SEP - 3 A 8:18
PHOENIX, ARIZONA

The owner(s) (claimants) of the above mining claims and sites are:

Michael James Marron
(Owner's Name - Please Print)

Michael James Marron
(Owner's Signature)

P.O. Box 1007
(Owner's Mailing Address)

Carefree AZ 85377-1007
(City) (State) (Zip Code)

(Owner's Name - Please Print)

(Owner's Signature)

(Owner's Mailing Address)

(City) (State) (Zip Code)

(Owner's Name - Please Print)

(Owner's Signature)

(Owner's Mailing Address)

(City) (State) (Zip Code)

(Owner's Name - Please Print)

(Owner's Signature)

(Owner's Mailing Address)

(City) (State) (Zip Code)

ENTERED
SEP 18 2019
BY *[Signature]*

[Signature]

| | | | |
|-------------------------------|---------------------|---------|------------|
| (Owner's Name - Please Print) | (Owner's Signature) | | |
| (Owner's Mailing Address) | (City) | (State) | (Zip Code) |
| | | | |
| (Owner's Name - Please Print) | (Owner's Signature) | | |
| (Owner's Mailing Address) | (City) | (State) | (Zip Code) |
| | | | |
| (Owner's Name - Please Print) | (Owner's Signature) | | |
| (Owner's Mailing Address) | (City) | (State) | (Zip Code) |
| | | | |
| (Owner's Name - Please Print) | (Owner's Signature) | | |
| (Owner's Mailing Address) | (City) | (State) | (Zip Code) |

18 U.S.C. 1001 and 43 U.S.C. 1212 make it a crime for any person knowingly and willfully to make to any department or agency of the United States any false, fictitious or fraudulent statements or representations as to any matter within its jurisdiction.

INSTRUCTIONS

1. This certification is made under the provisions of 43 U.S.C. § 1744 and 30 U.S.C. §28-28k and the regulations thereunder (43 CFR Part 3830).
2. The claimant(s) must fill in the dates in paragraph 1 for the beginning and ending of the assessment year for which this waiver is sought.
3. The claimant(s) must fill in the date in paragraph 2 for the beginning of the assessment year for which this waiver is sought.
4. All claim and site names and BLM serial numbers must be listed for the mining claims, mill sites, and tunnel sites for which the waiver is sought.
5. All owners of the mining claims, mill sites, and tunnel sites and their addresses must be given.
6. This waiver form must be signed by all the claimants or their designated agent, in original form. If an agent is designated, a notarized designation of agent, signed by all of the claimants with proper address given, must be submitted with this waiver.
7. This form must be filed no later than September 1st for the upcoming assessment year in the BLM State Office where the mining claims or sites are recorded, or the waiver cannot be granted by the BLM. (Example: To obtain a waiver for the assessment year 2012, which begins on September 1, 2011, you must qualify for and file for a waiver no later than September 1, 2011, in the proper BLM State Office.)
8. For all mining claims which require assessment work, you must record an affidavit of labor on or before the December 30th immediately following the filing of this waiver. For all other mining claims or sites waived, you must record a notice of intent to hold on or before the December 30th immediately following the filing of this waiver.
9. Mill and tunnel sites may also be listed on this waiver and be waived from payment of the maintenance fee. A notice of intent to hold for these sites is required to be filed by the December 30th following the filing of this waiver.

PHOENIX, ARIZONA
 2019 SEP -3 A 8:18
 RECEIVED BLM AZ STATE OFFICE

FOR OFFICIAL USE ONLY

NOTICE!!

These documents have been scanned!

Do not place un-scanned documents beneath this notice!

Do not remove this notice from this file!

GPO Jacket No. 560-102
Print Order 61540
Rise Business Services, LLC
Job=AZ15 5/21/2019



Box Number= AZ15075



Claim Begin-End: AMC452773-AMC452778

5 Miscellaneous



AZ15075-38

AMC452444-AMC452831

**NO
DOCUMENTS
FOUND**

NO DOCUMENTS FOUND
NO DOCUMENTS FOUND

NOTICE!!

These documents have been scanned!

Do not place un-scanned documents beneath this notice!

Do not remove this notice from this file!

GPO Jacket No. 560-102
Print Order 61540
Rise Business Services, LLC
Job=AZ15 5/21/2019



Box Number= AZ15075



Claim Begin-End: AMC452773-AMC452778

6 Location Notices-Amendments and Supporting Documents



AZ15075-38

AMC452444-AMC452831

MINING CLAIM STATUS REPORT

Data Entered: 01/31/2019

MTP Checked By: [Signature]
GEO Checked By: [Signature]

LEAD SERIAL NUMBER: AMC 452713 thru AMC 452718

NUMBER OF CLAIMS & TYPE:

- 6 LODE
- PLACER
- ASSOCIATION PLACER
- MILL SITE
- TUNNEL SITE

CHARGES:

Processing Fee @ \$20 = \$ 120-
 Location Fee @ \$37 = \$ 222-
 Maintenance Fee @ \$155 = \$ 930-
 Add'l Maint Fee for Assoc Placer = \$ _____
SUBTOTAL \$ 1272
 Other Fees \$ _____
 Other Fees \$ _____
TOTAL \$ _____

TOTAL ACREAGE: _____ Per Claim
(Placer Only)

NUMBER OF LOCATORS: 1

DOCUMENTS RECEIVED VIA : Over-the-Counter Mail TIMELY FILED: Yes No

LEGAL DESCRIPTION: T 6N R 4E SEC 14
 T _____ R _____ SEC _____
 T _____ R _____ SEC _____
 T _____ R _____ SEC _____
 T _____ R _____ SEC _____

BLM FOREST SERVICE WILDERNESS AREA SUBJ TO PL 359: Yes No

SPLIT ESTATE: N/A SX PX OTHER ?
SRHA Was proper Notice filed if located on SHRA Land? Yes No

RECONVEYED MINERALS ON BLM LAND REQUIRE OPENING ORDER FROM 1944 TO 1993:

Open to Entry On _____ N/A

COMMENTS/STATUS: VOID PARTIALLY VOID PVT MINERALS WITHDRAWN LANDS
OTHER

Claimant acknowledges that portions of the following claim(s) site(s) may be void or voidable.

Printed Name of Claimant _____ Signature of Claimant _____

*****FINAL ADJUDICATION*****

DATE _____ INITIALS _____

LOCATION NOTICE FOR LODE MINING CLAIM

Amendment BLM Serial # _____

NOTICE IS HEREBY GIVEN that the Mommy's Burden #1

_____ lode mining claim has been located

by Michael James Marron whose current mailing

address is P.O. Box 1007, Carefree, AZ 85377-1007

RECEIVED
BLM AZ STATE OFFICE
2018 DEC 19 P 3:04
PHOENIX, ARIZONA
BLM
Date
Stamp

The general course of this claim is easterly and it is situated in Maricopa County, Arizona. This claim is 1500 feet in length and 600 feet in width.

20 Total Claim Acreage. This claim runs from the location monument on which this location notice is posted on the centerline of the claim approximately 900 feet in a southern direction to the southern end line and 1500 feet in a easterly direction to the eastern end line. This claim is marked by six monuments, one at each corner and one at the center of each end line of the claim.

The location monument on which this notice is posted is situated within Section 14SW-NE, Township 6N, Range 4E, Gila Salt River Base and Meridian, Arizona and this claim encompasses portions of the following quarter section(s), section(s), Township(s) and Range(s) S1/2, SW-NE, Sec 14, T6N, R4E

Gila Salt River Base and Meridian, Arizona.

The locality of this claim with reference to some natural object or permanent monument and additional information (if any) concerning its locality are as follows: The western slope of Continental mountain in Cave Creek.

_____ The above information is shown on the attached map.

DATED AND POSTED on the ground this 15th day of December, 2018.

LOCATOR(s) AGENT

Print Name(s) Michael James Marron

Signature(s) Michael Marron

Form MCF100
Revised July 2014

This form is available from the Arizona Geological Survey and may be reproduced.

AMC452773

Total of Mommy's Burden 6 claims is 120 acreage

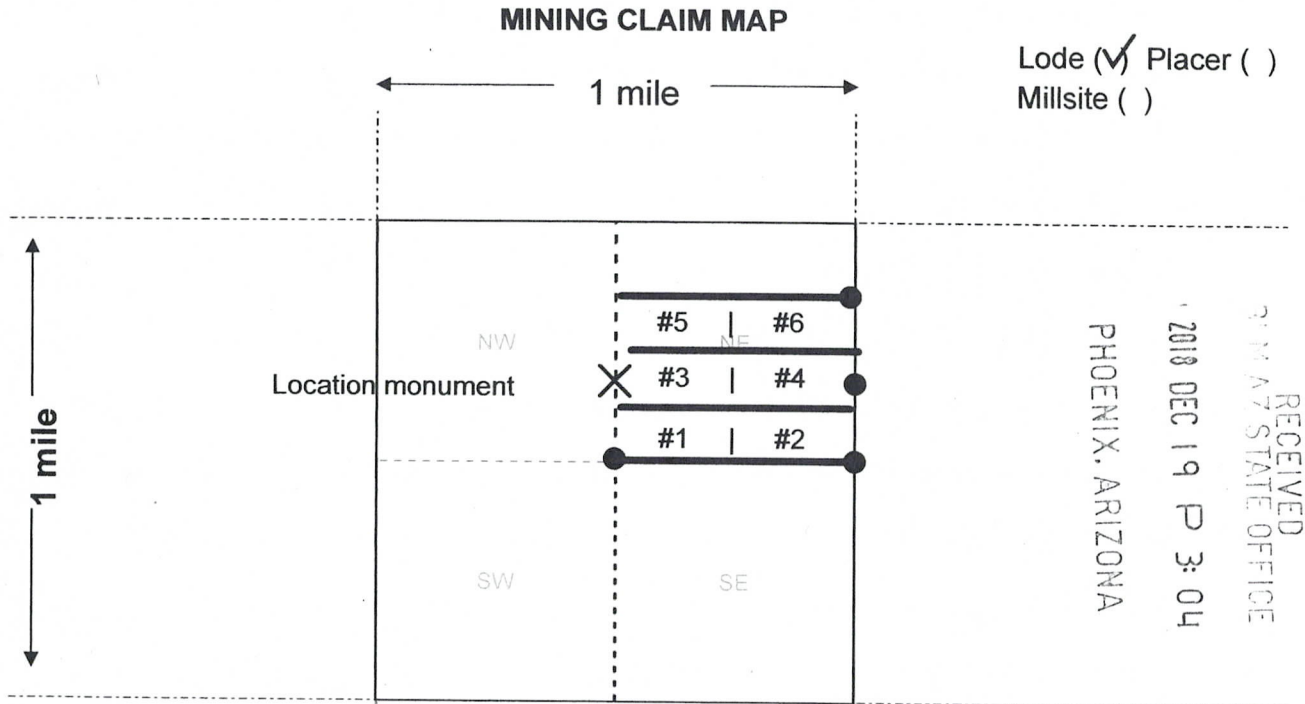

Scale: 1" = 2000 feet



1. The above map depicts the Mommy's Burden mining claim, which is located in Section (s) 14, Township 6N, Range 4E, Gila and Salt River Base and Meridian, Maricopa County, Arizona. Total claim acreage is 120
2. The type of corner and location monuments used are as follows: 1/1/2 inch ABS pipe 50 inches high
3. The bearings and distances in degrees and feet between claim corners and to a public land survey monument are as depicted on the map.
4. If the claim is a placer or millsite claim with exterior limits conforming to legal subdivisions of the public survey, provide a legal description of the claim S 3/4, NE 1/4, Section 14, Township 6 North, Range 4 East of the Gila and Salt River Meridian, Arizona

Form MCF100a
Revised July 2014

This form is available from the **Arizona Geology Survey** and may be reproduced.

AMC452113

LOCATION NOTICE FOR LODE MINING CLAIM

Amendment BLM Serial # _____

NOTICE IS HEREBY GIVEN that the Mommy's Burden #2
_____ lode mining claim has been located
by Michael James Marron whose current mailing
address is P.O. Box 1007, Carefree, AZ 85377-1007

RECEIVED
M AZ STATE OFFICE
2018 DEC 19 P 3:04
PHOENIX, ARIZONA
BLM
Date
Stamp

The general course of this claim is easterly and it is situated in Maricopa
County, Arizona. This claim is 1500 feet in length and 600 feet in width.

20 Total Claim Acreage. This claim runs from the location monument on which this location notice
is posted on the centerline of the claim approximately 900 feet in a southern direction to the southern
end line and 1500 feet in a easterly direction to the western end line. This claim is marked by six
monuments, one at each corner and one at the center of each end line of the claim.

The location monument on which this notice is posted is situated within Section 14SW-NE, Township 6N
_____, Range 4E _____, Gila Salt River Base and Meridian, Arizona and this claim encompasses portions
of the following quarter section(s), section(s), Township(s) and Range(s) S1/2 of SE-NE, Sec 14, T6N, R4E

Gila Salt River Base and Meridian, Arizona.

The locality of this claim with reference to some natural object or permanent monument and additional information
(if any) concerning its locality are as follows: The western slope of Continental mountain in Cave Creek.

_____. The above information is shown on the attached map.

DATED AND POSTED on the ground this 15th day of December, 2018.

LOCATOR(s) AGENT

Print Name(s) Michael James Marron

Signature(s) Michael James Marron

Form MCF100
Revised July 2014

AMC452774

LOCATION NOTICE FOR LODE MINING CLAIM

Amendment BLM Serial # _____

NOTICE IS HEREBY GIVEN that the Mommy's Burden #3
_____ lode mining claim has been located
by Michael James Marron whose current mailing
address is P.O. Box 1007, Carefree, AZ 85377-1007

RECEIVED
M A STATE OFFICE
2018 DEC 19 P 3:04
PHOENIX, ARIZONA
BLM
Date
Stamp

The general course of this claim is easterly and it is situated in Maricopa
County, Arizona. This claim is 1500 feet in length and 600 feet in width.

20 Total Claim Acreage. This claim runs from the location monument on which this location notice
is posted on the centerline of the claim approximately 300 feet in a southern direction to the southern
end line and 1500 feet in a easterly direction to the eastern end line. This claim is marked by six
monuments, one at each corner and one at the center of each end line of the claim.

The location monument on which this notice is posted is situated within Section 14SW-NE, Township 6N
_____, Range 4E _____, Gila Salt River Base and Meridian, Arizona and this claim encompasses portions
of the following quarter section(s), section(s), Township(s) and Range(s) N1/2 of SW-NE, Sec 14, T6N, R4E

Gila Salt River Base and Meridian, Arizona.

The locality of this claim with reference to some natural object or permanent monument and additional information
(if any) concerning its locality are as follows: The western slope of Continental mountain in Cave Creek.

_____ The above information is shown on the attached map.

DATED AND POSTED on the ground this 15th day of December, 2018.

LOCATOR(s) AGENT

Print Name(s) Michael James Marron

Signature(s) Michael James Marron

Form MCF100
Revised July 2014

This form is available from the Arizona Geological Survey and may be reproduced.

AMC452775

LOCATION NOTICE FOR LODE MINING CLAIM

Amendment BLM Serial # _____

NOTICE IS HEREBY GIVEN that the Mommy's Burden #4
_____ lode mining claim has been located
by Michael James Marron whose current mailing
address is P.O. Box 1007, Carefree, AZ 85377-1007

RECEIVED
BLM AZ STATE OFFICE
2018 DEC 19 P 3: 04
PHOENIX, ARIZONA
BLM
Date
Stamp

The general course of this claim is easterly and it is situated in Maricopa
County, Arizona. This claim is 1500 feet in length and 600 feet in width.

20 Total Claim Acreage. This claim runs from the location monument on which this location notice
is posted on the centerline of the claim approximately 300 feet in a southern direction to the southern
end line and 1500 feet in a easterly direction to the western end line. This claim is marked by six
monuments, one at each corner and one at the center of each end line of the claim.

The location monument on which this notice is posted is situated within Section 14SW-NE, Township 6N
4E, Range 4E, Gila Salt River Base and Meridian, Arizona and this claim encompasses portions
of the following quarter section(s), section(s), Township(s) and Range(s) N1/2 of SE-NE, Sec 14, T6N, R4E

Gila Salt River Base and Meridian, Arizona.

The locality of this claim with reference to some natural object or permanent monument and additional information
(if any) concerning its locality are as follows: The western slope of Continental mountain in Cave Creek.

_____ The above information is shown on the attached map.

DATED AND POSTED on the ground this 15th day of December, 2018.

LOCATOR(s) AGENT

Print Name(s) Michael James Marron

Signature(s) Michael James Marron

Form MCF100
Revised July 2014

This form is available from the Arizona Geological Survey and may be reproduced.

AMC452776

LOCATION NOTICE FOR LODE MINING CLAIM

Amendment BLM Serial # _____

NOTICE IS HEREBY GIVEN that the Mommy's Burden #5
_____ lode mining claim has been located
by Michael James Marron whose current mailing
address is P.O. Box 1007, Carefree, AZ 85377-1007

RECEIVED
BLM AZ STATE OFFICE
2018 DEC 19 P 3:04
PHOENIX, ARIZONA
BLM
Date
Stamp

The general course of this claim is easterly and it is situated in Maricopa
County, Arizona. This claim is 1500 feet in length and 600 feet in width.

20 Total Claim Acreage. This claim runs from the location monument on which this location notice
is posted on the centerline of the claim approximately 300 feet in a northern direction to the southern
end line and 1500 feet in a easterly direction to the eastern end line. This claim is marked by six
monuments, one at each corner and one at the center of each end line of the claim.

The location monument on which this notice is posted is situated within Section 14SW-NE, Township 6N
_____, Range 4E _____, Gila Salt River Base and Meridian, Arizona and this claim encompasses portions
of the following quarter section(s), section(s), Township(s) and Range(s) S1/2 of NW-NE, Sec 14, T6N, R4E

Gila Salt River Base and Meridian, Arizona.

The locality of this claim with reference to some natural object or permanent monument and additional information
(if any) concerning its locality are as follows: The western slope of Continental mountain in Cave Creek.

_____ The above information is shown on the attached map.

DATED AND POSTED on the ground this 15th day of December, 2018.

LOCATOR(s) AGENT

Print Name(s) Michael James Marron

Signature(s) Michael James Marron

Form MCF100
Revised July 2014

This form is available from the Arizona Geological Survey and may be reproduced.

AMC4521771

LOCATION NOTICE FOR LODE MINING CLAIM

Amendment BLM Serial # _____

NOTICE IS HEREBY GIVEN that the Mommy's Burden #6
_____ lode mining claim has been located
by Michael James Marron whose current mailing
address is P.O. Box 1007, Carefree, AZ 85377-1007

RECEIVED
BLM AZ STATE OFFICE
2018 DEC 19 P 3:04
PHOENIX, ARIZONA
BLM
Date
Stamp

The general course of this claim is easterly and it is situated in Maricopa
County, Arizona. This claim is 1500 feet in length and 600 feet in width.

20 Total Claim Acreage. This claim runs from the location monument on which this location notice
is posted on the centerline of the claim approximately 300 feet in a northern direction to the southern
end line and 1500 feet in a easterly direction to the western end line. This claim is marked by six
monuments, one at each corner and one at the center of each end line of the claim.

The location monument on which this notice is posted is situated within Section 14SW-NE, Township 6N
4E, Range 4E, Gila Salt River Base and Meridian, Arizona and this claim encompasses portions
of the following quarter section(s), section(s), Township(s) and Range(s) S1/2 of NE-NE, Sec 14, T6N, R4E

Gila Salt River Base and Meridian, Arizona.

The locality of this claim with reference to some natural object or permanent monument and additional information
(if any) concerning its locality are as follows: The western slope of Continental mountain in Cave Creek.

The above information is shown on the attached map.

DATED AND POSTED on the ground this 15th day of December, 2018.

LOCATOR(s) AGENT

Print Name(s) Michael James Marron

Signature(s) Michael James Marron

Form MCF100
Revised July 2014

This form is available from the **Arizona Geological Survey** and may be reproduced.

AMC452778



LR2000 Internal

CR Geographic Report with Land

[Download User Guide \(pdf\)](#)

Purpose: This report produces a geographic listing of case information based on retrieval by Meridian/Township/Range. This report format will display the case type, case disposition, meridian, township, range, section, survey type, survey number, surface management agency, pending actions, serial number, and total case acres.

To refresh the query, do a **Ctrl-R**. It resets the page and clears any criteria fields that may have entries.



No Results

The specified criteria didn't result in any data. This is often caused by applying filters and/or selection steps that are too restrictive or that contain incorrect values. Please check your analysis filters and selection steps, and try again. The filters or selection steps currently being applied are shown below.

Filters

Meridian Township Range Section is equal to **14 0060N 0040E 014**
and Admin State is equal to **AZ**

